

SUBMITTAL DATA SHEET

NI_G_IN_00100.docx
Rev. -1 of 27/05/2024



NIRON CLIMA SOCKET FUSION FITTING CONCENTRIC REDUCING (SOCKET x SOCKET)



ITEM: 27NRC_
SIZE RANGE: 1¼" x 1" (40 mm x 32 mm) ÷ 4" x 3½" (125 mm x 110 mm)
SDR: 7.4
FUSION RANGE: For Socket Fusion – SDR7.4 and up
MATERIAL: PP-RCT (Borealis RA 7050 beta crystalline random copolymer PP)
COLOR: Steel Grey

INSTALLATION INSTRUCTIONS:

Socket fusion - Socket Fusion in accordance with DVS 2207, ASTM D2657 and NUPI Niron Installation Manual

LISTINGS:

NSF PW; ANSI/NSF 14; ANSI/NSF 61; ANSI/NSF 51; UPC; IPC; IAPMO; ICC-ES; CAN/UCL S102; CAN/UCL S115*

STANDARDS:

ANSI/NSF 14; ANSI/NSF 61; ASTM F2389; ASTM F2023; CSA B137,11; ASTM E-84****; CAN/ULC S102****; NSF 51; ISO 15874

MAXIMUM OPERATING PRESSURE:

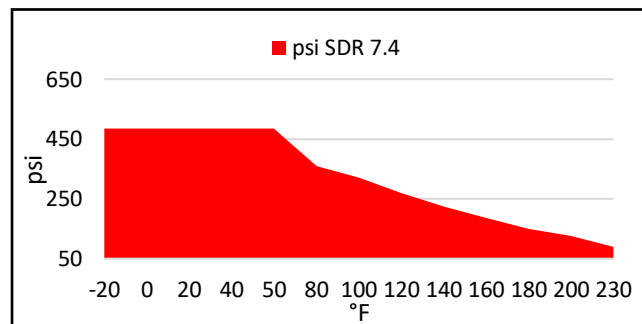

For code or standard question pertaining to NIRON CLIMA Pipe and Fittings, contact Nupi Americas.

PRODUCT INFORMATION AND APPLICATION USE:

Niron Socket Fusion Fittings are designed to be joined by means of heat element socket fusion in accordance with the above listed installation instructions. Fittings are manufactured with imbedded sockets on each side which are of a tapered interference fit. The dimensions of the fittings and sockets are in accordance with the requirements of ASTM F2389. The fittings are designed with sufficient thickness to exceed the pressure ratings of the thickest NIRON commercially available pipe and can be used to join to a Niron pipe of any thickness. Fittings are unitary and injection molded and are solid grey in color.



Nupi Americas, Inc.
314 Commerce Parkway
Early Branch, SC 29916
Phone: 813-398-3579
Fax: 813-398-3639
Mail: info@nupiamericas.com
Website: www.nupiamericas.com

SUBMITTAL DATA SHEET

NI_G_IN_00100.docx
Rev. -1 of 27/05/2024

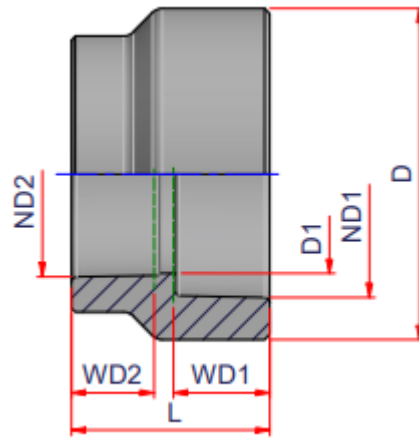

CODE	Weight lbs/pc	Volume ft ³ /pc	ND1	ND2	D	D1	WD1	WD2	L
27NRC4032	0.083	0.0052	1 1/4" => 40 mm	1" => 32 mm	2.2	1.18	13/16	11/16	1.85
27NRC5032	0.107	0.0078	1 1/2" => 50 mm	1" => 32 mm	2.48	1.18	15/16	11/16	2.19
27NRC5040	0.107	0.0073	1 1/2" => 50 mm	1 1/4" => 40 mm	2.48	1.46	15/16	13/16	2.05
27NRC6340	0.235	0.0154	2" => 63 mm	1 1/4" => 40 mm	3.39	1.46	1 1/16	13/16	2.32
27NRC6350	0.262	0.0162	2" => 63 mm	1 1/2" => 50 mm	3.39	1.81	1 1/16	15/16	2.44
27NRC7550	0.368	0.0218	2 1/2" => 75 mm	1 1/2" => 50 mm	3.78	1.81	1 3/16	15/16	2.64
27NRC7563	0.346	0.0208	2 1/2" => 75 mm	2" => 63 mm	3.78	2.28	1 3/16	1 1/16	2.52
27NRC9063	0.529	0.0361	3" => 90 mm	2" => 63 mm	4.72	2.4	1 5/16	1 1/16	2.8
27NRC9075	0.66	0.0366	3" => 90 mm	2 1/2" => 75 mm	4.72	2.84	1 5/16	1 3/16	2.84
27NRC11075	0.821	0.0589	3 1/2" => 110 mm	2 1/2" => 75 mm	5.51	2.81	1 7/16	1 3/16	3.35
27NRC11090	0.996	0.0604	3 1/2" => 110 mm	3" => 90 mm	5.51	3.35	1 7/16	1 5/16	3.44
27NRC12590	1.691	0.0944	4" => 125 mm	3" => 90 mm	6.5	3.39	1 9/16	1 5/16	3.86
27NRC125110	1.675	0.0944	4" => 125 mm	3 1/2" => 110 mm	6.5	4.09	1 9/16	1 7/16	3.86

MANUFACTURER'S WARRANTY:

Thirty (30) Years from the date of sale upon successful completion of pressure test of the piping system (refer to published warranty for complete details).

NOTE:

* For unexposed service only with CAN/UCL S115 listed 1" thick fiberglass insulation.

** More information can be found on NIRON TECHNICAL CATALOGUE

*** Weld Depth (WD) is the insertion depth of the pipe for socket fusing

**** For Niron pipe and fittings to meet E-84 and/or CAN/ULC S102.2 for installation in a plenum application, it must be covered with a minimum of 1" or greater E-84 fiberglass insulation

***** Technical Data may undergo dimensional changes, check revision at the top

***** The actual pressure ratings of Niron PP-RCT socket fusion fittings meet or exceed the pressures indicated in the graph, which are for SDR 7.3 PP-RCT pipe



Nupi Americas, Inc.
314 Commerce Parkway
Early Branch, SC 29916
Phone: 813-398-3579
Fax: 813-398-3639
Mail: info@nupiamericas.com
Website: www.nupiamericas.com